



Being unexpected means being noticed, showing oneself, revealing oneself. Xcircle is not only a lighting system, but also a style that generates a desire for light and colour that allows us to build our own personality, shape by shape, piece by piece.

The Xcircle modules enable you to be unique and to transform everything that surrounds you in the image of your own thoughts and of your own imagination. A house, a store, an office – everything is seen in a different light with Xcircle.

Xcircle is a modular luminaire designed to offer solutions, combinations and lighting options that are unique and unrepeatable. Each module is composed of a main housing in white opaline polyethylene and of a steel sheet base plate. The four ends are completed with caps made of the same material as the main luminaire housing. When they have no caps, these ends may be coupled with multiple modules to create an endless web of light. These modules can also be alternated: direct light, indirect light and blind modules (mainly used as structural connection elements). The standard finishing of these latter versions is a shiny white coating. The module is available in a single size and can accommodate two T5 21W to 39W linear fluorescent lamps, with multipower electronic ballast. The use of simple mounting and connecting kits provides various installation options. Xcircle is also available in a colour-changing version based on the RGB synthesis technology. In this case, the light sources can be adjusted both in terms of light intensity and in colours: green, red and blue.

Optical components and light sources.

This series can accommodate T5 21W to 39W linear fluorescent lamps with white light and LED RGB colour synthesis lamps.

Structural features

Installation: high-bay, wall, ceiling

Luminaire housing: polycarbonate and steel sheet

Light sources: T5 linear fluorescent lamps

Accessories: kits for ceiling and wall, both for single module and for multiple modules

Finishing: white opaline or coated louver

Insulation class: I 

Power supply: 230V - 50Hz

| FLUORESCENT LAMPS | | |
|---|--------------|-----|
|  | FDH (T) - G5 | 21W |
| | FDH (T) - G5 | 39W |
| RGB LED | | |
| | 102 LED smd | 25W |

High-bay, ceiling and wall luminaire for T5 fluorescent lamps with direct and indirect light.
Equipped with multipower electronic ballast.

| CODE | DESCRIPTION |
|----------------------------|--|
| 6900 6901 | Module complete with frame and multipower ballast With white opaline louver With white coated louver FDM (T) - 2 x 21W / 39W - G5 230V - 50Hz Colour: 01 |
| 6902 6903 | Empty module With white opaline louver Con schermo verniciato bianco Colour: 01 |
| 360 361 | Side caps White opaline finishing White coated finishing Colour: 01 |
| 362 | Power supply kit Ceiling rose with power supply cable Length of cables: 2500 mm |
| 365 | High-bay fixing kit n° 1 steel supporting cable with quick-fix system Maximum length: 2 meters (adjustable) |
| 350 | High-bay fixing kit for single module n° 2 steel supporting cables with quick-fix system |
| 363 | Module electrical connection kit Cable complete with two connectors |
| 366 | Module mechanical connection kit n° 2 devices |
| 367 | Wall mounting kit n° 2 supports |

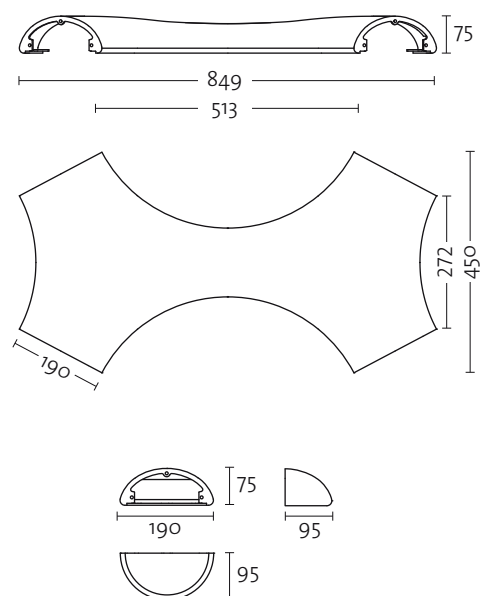

Size (mm)

01 white

NOTE

CONFIGURATION EXAMPLES FOR HIGH-BAY INSTALLATION

