

The luminaires of the Vacuum series have been designed for recessed mounting into false ceilings. Their aesthetic and performance features make them the ideal lighting solution for public and contract spaces, such as stores, hotels, banks, large retail areas, exhibition venues. The domed diffuser is available in two variants (concave or convex) that can be used within the same project, in order to meet the double need for lighting the environment and for creating lighting effects on the ceilings and walls where they are placed, which can move their structure and make it almost dynamic.

Technical specifications

Designed for recessed mounting, these luminaires are made of a structure of coated steel sheet, completed by an outer plaster frame, with standard white finish. The diffuser of white opaline polycarbonate, either in the concave or in the convex version, is fixed to the panel. Vacuum is available in two sizes, both with square frame: 595 x 595 mm complete with 400 mm diameter diffuser; 770 x 770 mm with 600 mm diffuser.

Structural features

Installation: recessed mounting for false ceilings

Luminaire housing: coated steel sheet structure, plaster front frame

Diffuser: white opaline polycarbonate

Standard finishing: white

Light sources: compact fluorescent lamps

4 x 24 Watt or 4 x 36 Watt

Protection class: IP40



Insulation class: I 

Power supply: 230V - 50 Hz

Light sources

The Vacuum luminaires accommodate compact fluorescent lamps, 4 x 24 Watt for the version with frame 595 mm long; 4 x 36 Watt for the version with frame 770 mm long.

FLUORESCENT LAMPS

	FSDH - 2G11	24W
	FSDH - 2G11	36W



Recessed luminaire with direct light for compact fluorescent lamps.
Coated steel sheet structure and plaster modular panels.
White opaline polycarbonate diffuser with concave or convex surface.
Equipped with electronic ballast.

VACUUM

DESIGN - ANDREA ZANINI, AZ DESIGN

CODE	DESCRIPTION	
9770	Diffuser with concave surface Module dimensions 595 x 595 mm Diffuser diameter 400 mm FSDH (TC-L) - 4 x 24W - 2G11 230V - 50Hz Colour: 01 IP 40	  CE  596
9771	Diffuser with concave surface Module dimensions 770 x 770 mm Diffuser diameter 600 mm FSDH (TC-L) - 4 x 36W - 2G11 230V - 50Hz Colour: 01 IP 40	  CE  771
9775	Diffuser with convex surface Module dimensions 595 x 595 mm Diffuser diameter 400 mm FSDH (TC-L) - 4 x 24W - 2G11 230V - 50Hz Colour: 01 IP 40	  CE  596
9776	Diffuser with convex surface Module dimensions 770 x 770 mm Diffuser diameter 600 mm FSDH (TC-L) - 4 x 36W - 2G11 230V - 50Hz Colour: 01 IP 40	  CE  771



	9770	9771	9775	9776
A	220	220	220	220
B	595	770	595	770
C	595	770	595	770

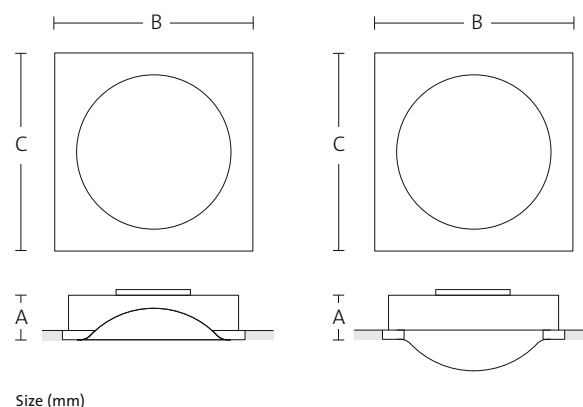

01 white

NOTE





